

TLG08

PRESSURE GOVERNOR WITH
CAVITATION WARNING

LCD DISPLAY

WATER TANK LEVEL GAUGE

CAN BUS COMPATIBLE

USER-DEFINED KEYS AND
WARNING LIGHTS



LEVEL INDICATOR

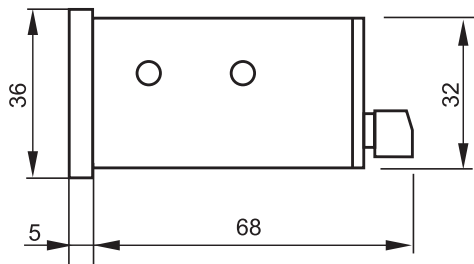

CUT OUT FOR THE CONTROL PANEL

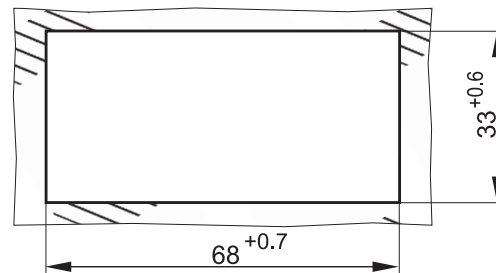

Specifications

Power supply	10 V ... 30 V DC
Power consumption*	approx. 3 W
Alarm relay output	Power supply voltage, max. 6 A
Pressure range	0...600 mbar (0...6 m tank height)
Level indication	9 x ultra bright LEDs
Detectable substances	Water, Fire-smothering foam, Oil, Gasoline,...
Transducer Electrical Connection	M12x1
Transducer pressure port fitting	G 1/4" with adapter G1/2"
Transducer Housing	Stainless steel 316L
Enclosure protection (IEC 529)	IP67 (Transducer); IP67 (Indicator-front panel)
Operating temperature-indicator	from -45 °C to +85 °C
Dimensions of the indicator (IEC 61554)	72x36x68 mm or 77.5x41.5x68 with Aluminium Bezel (LxHxW)
Transducer cable	3 x 0,25/35 mm ² (chemical and oil resistant) + connector M12
Weight	Transducer: 0,1 kg, Indicator: 0,1 kg

*No outputs active

Tank Level Gauge



Tank Level Gauge - TLG08 is designed to display a liquid's volume at an accuracy level of 1/8 of the tank using 9 ultra-bright LEDs. For example, when the tank level is below 1/4 the LED at 1/8 is flashing, when the tank level is below 1/8 the red LED at 0 turns on. As an additional option an external device (such as buzzer or siren) can be controlled by a relay output pin on the indicator unit.

The indicator is able to communicate with the other displays (Remote Indicators) via the one wire datalink. The unit uses a 0-600mbar (0-8.7PSI) temperature-compensated pressure transducer to obtain tank level information. The transducer measures the column of the liquid in the tank above the opening of the elbow and provides a signal that is proportional to the volume.

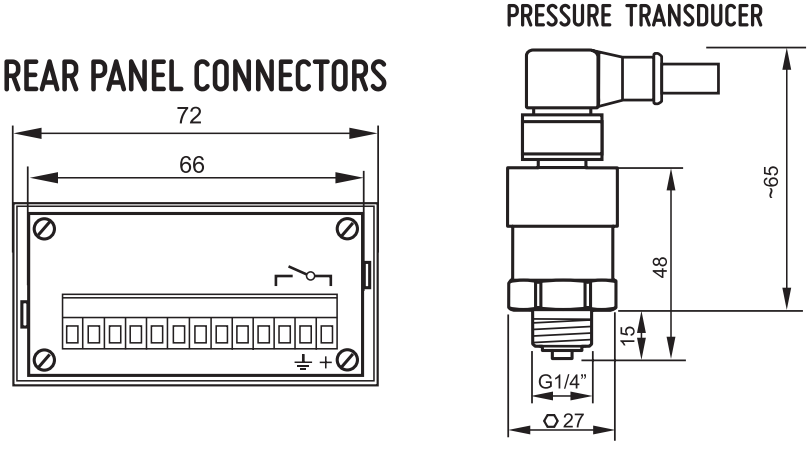

Ordering information

TLG08 - W - 5 - R - H95/65 - LLD

<p>DETECTABLE MEDIA W ... water F ... foam</p>	<p>SENSOR CABLE LENGTH IN M 3, 5, 10 m... (standard)</p>	<p>ALARM OUTPUT R- relay output max.6A (tank level < 1/8)</p>	<p>AUTO-FILL H95/75 95% valve close, 75% valve open (H95/50, H95, ...)</p>	<p>LARGE LIGHT DRIVER 5X40W LLD5 ... large light driver for level 0, 1/4, 1/2, 3/4, 1</p>
---	---	---	--	---

TLG04ASW

4 ULTRA BRIGHT LEDs,
VIEWING ANGLE 170°

CREW PROTECTION AND LOW
WATER WARNING OUTPUTS
WITH MUTE INPUT

HYSTERESIS OUTPUT, AUTOFILL

REMOTE INDICATOR OR LARGE
TANK INDICATOR CONECTION

PHOTO SENSOR

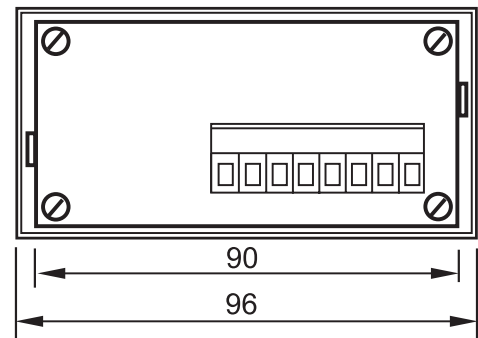
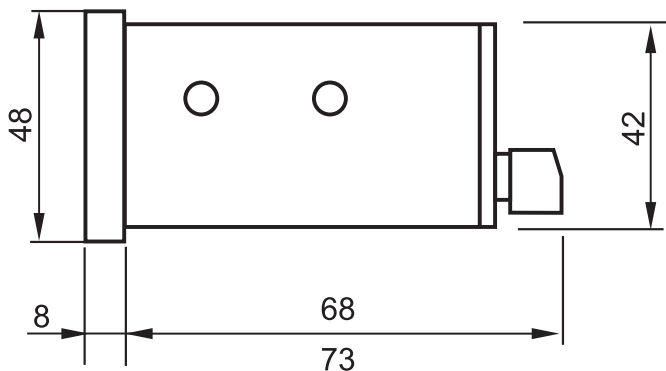

Specifications

Power supply	10 V ... 30 V DC
Power consumption*	approx. 3 W
Output	2x relay 1A, 6x MosFet 2A
Pressure range	0...600 mbar (0...6 m tank height)
Level indication	4 x ultra bright LEDs
Detectable substances	Water
Transducer Electrical Connection	M12x1
Transducer pressure port fitting	G 1/4" with adapter G1/2"
Transducer Housing	Stainless steel 316L
Enclosure protection (IEC 529)	IP67 (Transducer); IP67 (Indicator-front panel)
Operating temperature-indicator	from -45 °C to +85 °C
Dimensions of the indicator (IEC 61554)	98x48x68 (LxHxW)
Transducer cable	3 x 35 mm ² + connector M12, IP67
Weight	Transducer: 0,1 kg, Indicator: 0,1 kg

*No outputs active

Tank Level Gauge



Tank Level Gauge - TLG04ASW is designed to display a liquid's volume at an accuracy level of 1/4 of the tank using 4 ultra-bright LEDs. For example, when the tank level is 1/4 the LED at 1/4 is on, when the tank level is below 1/4 the LED at 1/4 is flashing. As an additional option an external device (such as buzzer, siren, valve, PLC, etc) can be controlled by a two relay outputs or six MFet outputs pin on the indicator

unit. The indicator is able to communicate with the other displays (Remote Indicators) via the one wire datalink. The unit uses a 0-600mbar (0-8.7PSI) temperature-compensated pressure transducer to obtain tank level information. The transducer measures the column of the liquid in the tank above the opening of the elbow and provides a signal that is proportional to the volume.

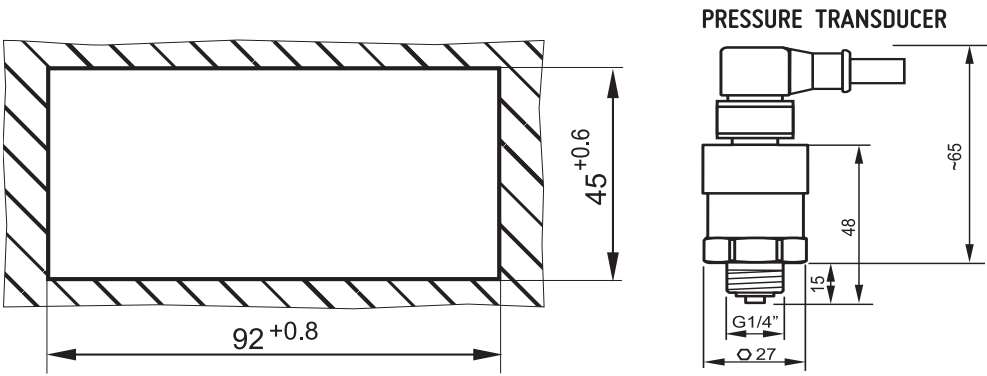

Ordering information

TLG04ASW - 5 - A - B - M - H

<p>DETECTABLE MEDIA W ... water</p>	<p>SENSOR CABLE LENGTH IN M 3, 5, 10 m... (standard)</p>	<p>WARNING LIGHTS Crew protection warning lights output</p>	<p>WARNING BUZZER Crew protection warning buzzer output</p>	<p>MUTE Mute input for buzzer output</p>	<p>HYSTERESIS OUTPUT Amber strobe and warning lights</p>
--	---	--	--	---	---

TLG20D

2 1/2-DIGIT ULTRA-BRIGHT LEDS,
% READINGS

AUTO-FILL FUNCTION

LOW WATER ALARM OUTPUT

LARGE LIGHT DRIVER

REMOTE INDICATOR



LEVEL INDICATOR

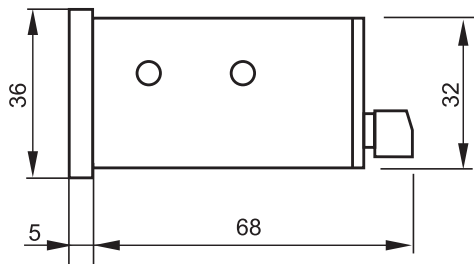

CUT OUT FOR THE CONTROL PANEL

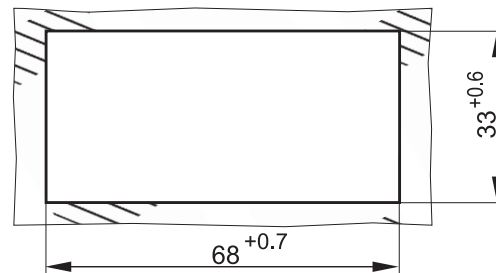

Specifications

Power supply	10 V ... 30 V DC
Power consumption*	approx. 3 W
Alarm relay output	Power supply voltage, max. 6 A
Pressure range	0...600 mbar; 8.7 PSI (0...6 m tank height)
Level indication	3 x 7 seg. LED displays (super bright), 0 - 100%, 5% step
Detectable substances	Water, Fire-smothering foam, Oil, Gasoline,...
Transducer Electrical Connection	M12x1
Transducer pressure port fitting	G 1/4" with adapter G1/2"
Transducer Housing	Stainless steel 316L
Enclosure protection (IEC 529)	IP67 (Transducer); IP65 (Indicator-front panel)
Operating temperature-indicator	from -45 °C to +85 °C
Dimensions of the indicator (IEC 61554)	72x36x68 mm or 77.5x41.5x68 with Aluminium Bezel (LxHxW)
Transducer cable	3 x 0,25/35 mm ² (chemical and oil resistant) with connector M12
Weight	Transducer: 0,1 kg, Indicator: 0,1 kg

*No outputs active

Tank Level Gauge



Tank Level Gauge - TLG20D is designed to display a liquid's volume to 5% tank level accuracy with a 7 segment ultra-bright LED display. When the tank level is below 25% the display flashes and when the tank level is below 10% the relay output is turned on (optional).The indicator is able to communicate with other displays (remote indicators) over the one wire datalink.

The unit uses a 0-600 mbar (0-8.7 PSI) temperature compensated pressure transducer to obtain tank level information. The transducer measures the column of liquid in the tank above the opening of the elbow and provides a signal that is proportional to the volume.

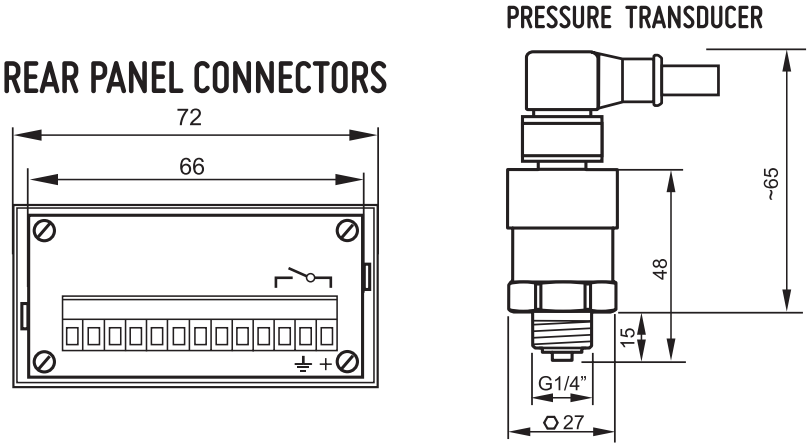

Ordering information

TLG20D - W - 5 - R - H95/75 - LLD

<p>DETECTABLE MEDIA W ... water F ... foam</p>	<p>SENSOR CABLE LENGTH IN M 3, 5, 10 m... (standard)</p>	<p>ALARM OUTPUT R- relay output max.6A (tank level < 1/8)</p>	<p>AUTO-FILL H95/75 95% valve close, 75% valve open (H95/50, H95, ...)</p>	<p>LARGE LIGHT DRIVER 5X40W LLD5 ... large light driver for level 0, 1/4, 1/2, 3/4, 1</p>
---	---	---	--	---

TLG4DL

4-DIGIT ULTRA-BRIGHT LEDS

AUTO-FILL FUNCTION

LOW WATER ALARM OUTPUT

LARGE LIGHT DRIVER

REMOTE INDICATOR



LEVEL INDICATOR

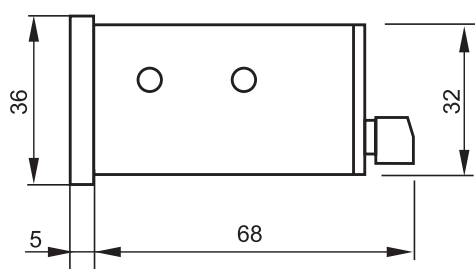

CUT OUT FOR THE CONTROL PANEL

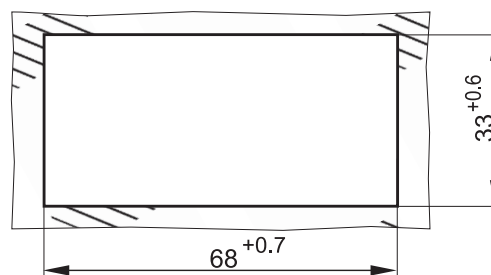

Specifications

Power supply	10 V ... 30 V DC
Power consumption*	approx. 3 W
Alarm relay output	Power supply voltage, max. 6 A
Detection method	Conductive
Level indication	5 x LEDs (ultra bright)
Detectable substances	Water, Current conductive liquids
Probe fitting	G 5/4" with O-ring (NBR)
Electrodes Material	wire with Sn ends, Stainless steel ground electrode
Enclosure protection (IEC 529)	IP67 Probe; IP67 Indicator (front panel)
Operating temperature - indicator	from -45 °C to +85 °C (from -49 °F to +185 °F)
Dimensions of the indicator (IEC 61554)	72x36x68 mm or 77.5x41.5x68 with Aluminium Bezel (LxHxW)
Probe cable	5 x 0,25 + connector M12
Weight	Probe (1 m): 0.8 kg, Indicator: 0,1 kg

*No outputs active

Tank Level Gauge



The Tank Level Gauge series - TLG 4DL is designed to display a liquid's volume at an accuracy level of min. 1% of the tank using 4 digit ultra-bright LED display. The TLG can be calibrated to any shape/size of the tank. As an additional option an external device (such as buzzer, siren or el.valve) can be controlled by a relay output pin on the indicator unit.

The indicator is able to communicate with the other displays (Remote Indicators) via the one wire datalink. The unit uses a pressure transducer to obtain tank level information. The transducer measures the column of the liquid in the tank above the opening of the elbow and provides a signal that is proportional to the volume.

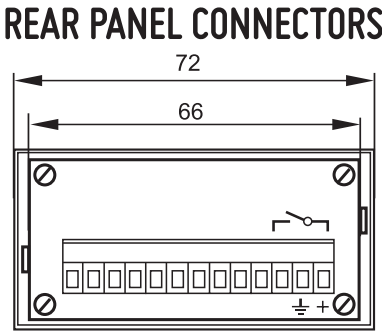

PRESSURE TRANSDUCER

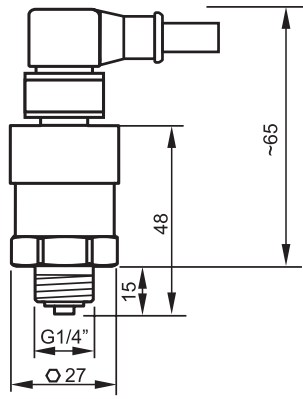

Ordering information

TLG4DL - W - 5 - R - H95/75 - LLD

<p>DETECTABLE MEDIA W ... water F ... foam</p>	<p>SENSOR CABLE LENGTH IN M 3, 5, 10 m... (standard)</p>	<p>ALARM OUTPUT R- reley output max.6A (tank level < 1/8)</p>	<p>AUTO-FILL H95/75 95% valve close, 75% valve open (H95/50, H95, ...)</p>	<p>LARGE LIGHT DRIVER 5X40W LLD5 ... large light driver for level 0, 1/4, 1/2, 3/4, 1</p>
---	---	---	--	---

RTS

5-DIGIT ULTRA-BRIGHT LEDS

AUTO-FILL FUNCTION

LOW WATER ALARM OUTPUT

LARGE LIGHT DRIVER

PHOTO SENSOR



INDICATOR

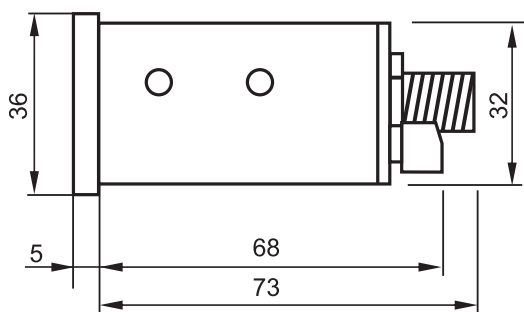

REAR PANEL CONNECTORS

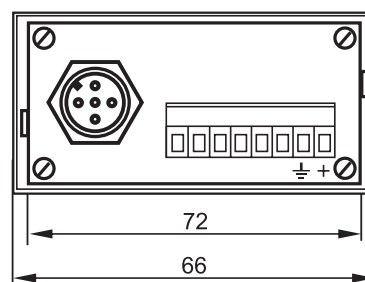

Specifications

Power supply	10 V ... 30 V DC
Power consumption*	approx. 3 W
Alarm relay output	Power supply voltage, max. 6 A
Detection method	Conductive
Level indication	5 x LEDs (ultra bright)
Detectable substances	Water, Fire-smothering foam, Current conductive liquids
Probe fitting	G 5/4" with O-ring (NBR)
Electrodes Material	1.4305 stainless steel
Enclosure protection (IEC 529)	IP67 Probe; IP67 Indicator (front panel)
Operating temperature - indicator	from -45 °C to +85 °C (from -49 °F to +185 °F)
Dimensions of the indicator (IEC 61554)	72x36x68 mm or 77.5x41.5x68 with Aluminium Bezel (LxHxW)
RTS-AU	96x48x73 mm or 103x55x73 with Aluminium Bezel (LxHxW)
Probe cable	5 x 0,25 + connector M12
Weight	Probe (1 m): 0.8 kg, Indicator: 0,1 kg

*No outputs active

Tank Level Gauge



Tank Level Gauge - RTS operates based on the conductance of the measured liquids. The electrodes are placed at each quarter length of the probe. The LED indicator (ultra-bright LED) signals the level of the liquid. The red LED indicates that the liquid level has reached less than 25%.

As an additional option, an external device (such as a buzzer or siren) can be controlled by a relay output pin on the indicator unit. The indicator is able to communicate with the other displays (Remote Indicators) via the 1-wire datalink.



CUT OUT FOR THE CONTROL PANEL

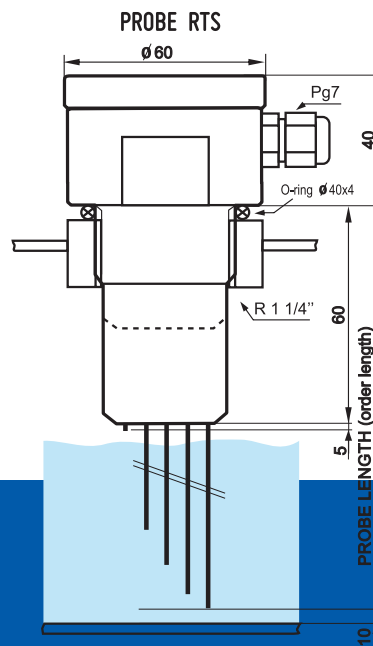
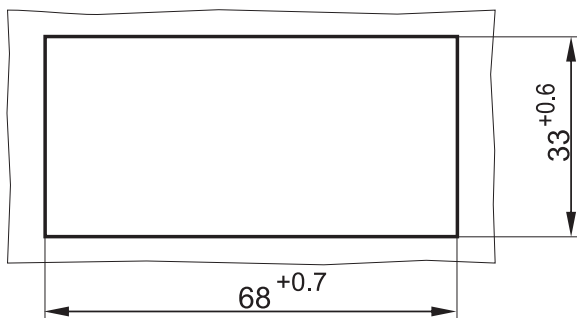

Ordering information

RTS - W - 1200 - 5 - R - H100/75 - LLD

DETECTABLE MEDIA W ... water F ... foam	PROBE LENGTH IN MM 200 ... 1500 mm	SENSOR CABLE LENGTH IN M 3, 5, 10 m... (standard)	ALARM OUTPUT R- relay output max.6A (tank level < 1/8)	AUTO-FILL H100/75 100% valve close, 75% valve open (H95/50, H95, ...)	LARGE LIGHT DRIVER 5X40W LLD5 ... large light driver for level 0, 1/4, 1/2, 3/4, 1
--	---	--	---	--	---