

DPI

VACUUM, LOW AND HIGH PRESSURE INDICATION

BAR OR KPA VERSION

ALARM OUTPUT

FACTORY CALIBRATED



PRESSURE INDICATOR

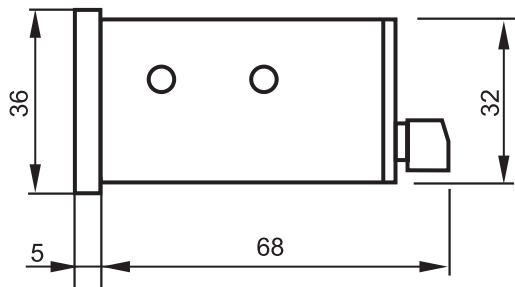

CUT OUT FOR THE CONTROL PANEL

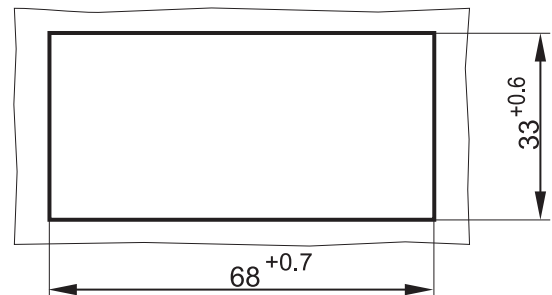

Specifications

Power supply	10 V ... 30 V DC
Power consumption*	approx. 3 W
Alarm relay output	Power supply voltage, max. 6 A
Pressure (reading) range	0 to 19.9 bars; 0 to 60 bars; -1.0 to 19.9 bars
Reading accuracy	20 bars and vacuum indicator: 0,1 bar; 60 bars indicator: 1 bar:
Pressure indication	2 1/2 digit LED display (super bright),
Transducer Electrical Connection	M12x1
Transducer pressure port fitting	G 1/4"
Transducer Housing	Stainless steel 316L
Enclosure - protection (IEC 529)	IP67 (Transducer); IP67 (Indicator-front panel)
Operating temperature-indicator	from -45 °C ... +85 °C
Dimensions of the indicator (IEC 61554)	72x36x68 mm or 77.5x41.5x68 with Aluminium Bezel (LxHxW)
Transducer cable	3x0,35mm ² (chemical and oil resistant) with connector M12,
Weight	Transducer: 0,1kg, Indicator: 0,1kg

*No outputs active

Digital Pressure Indicator

The Digital Pressure Indicator - DPI is available in various ranges -from 0 to 20 bars, 0 to 60 bars and also as vacuum indicator from -1 to 20 bars. The Stainless steel pressure transducer obtain pressure information which is displayed on a 2 ½ digit super bright LED display.

Two optional relay outputs can be programmed to meet customer needs (They switch when the pressure is within the limits or exceeds the limits, either over or under the limit). The indicator is able to communicate with other displays (remote pressure indicators) over the one wire datalink.

REAR PANEL CONNECTORS

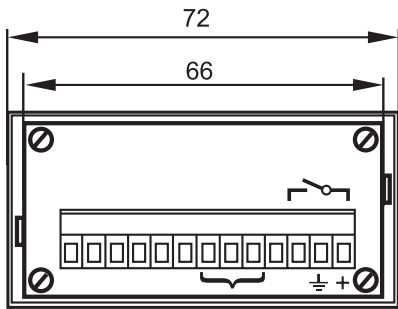

PRESSURE TRANSDUCER

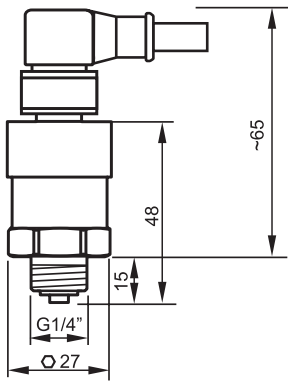

Ordering information

DPI - 20B - 3 - R>16

<p>PRESSURE MEASURING RANGE</p> <p>20B -0...19,9 bar 60B -0...60 bar V20B -1...20 bar</p> <p>2000kPa -0...2000 kPa 6000kPa -0...6000 kPa V2000kPa -1...2000 kPa</p>	<p>SENSOR CABLE LENGTH IN M</p> <p>3, 5, 10 m... (standard)</p>	<p>ALARM OUTPUT</p> <p>Relay condition: pressure value or pressure range:</p> <p>R <3 alarm when the pressure is less than 3 bars R >16 alarm when the pressure is more than 16 bars R 3 > <8 alarm when the pressure is between 3 to 8 bars R 3 <> 8 alarm when the pressure is between 3 to 8 bars</p>
--	---	--